

Office to let

The Bridge Business Park - Phase II

Bucharest, Sector 6, Sergent C-Tin Ghercu 1A st.



Building information

| | |
|----------------------|-------------|
| Building status | Existing |
| Year of construction | 2019 |
| Parking ratio | 1 / 60 sq m |
| Total building area | 35 280 sq m |

Commercial terms

| | |
|--------------------|---------------|
| Office space* | after login * |
| Parking | after login * |
| Service charge* | after login * |
| Minimum lease term | after login * |
| Availability | after login * |

* Asking terms for m²/month

Location



Available space

Building completely leased

Typical floor plan

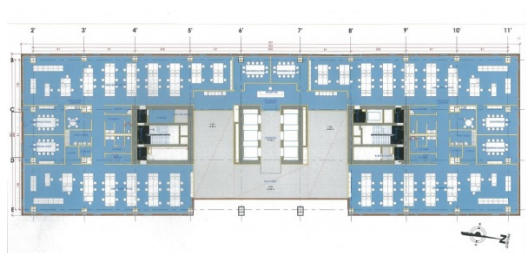

Public transport

Metro: M1, M4

Bus: 105

Tram: 1, 11, 35

Contact



+40 21 302 3400

More information